



**PIPE SUPPORT
SYSTEMS
CATALOGUE**





Contents

1 Pipe Supports

Insulated Pipe Clamps ZP & SS.....	Page 1-2
Stabil Pipe Clamps.....	Page 3
Channel Clips & Hydrosorbs	Page 4
Sprinkler Supports.....	Page 5
Heavy Duty U Bolts, Guides & Grips	Page 6
U Bolts, Medium Duty Clamps & Saddles.....	Page 7-8
Isolation Barrier, Barnogs & Blocks.....	Page 9
Gas Boxes & Accessories.....	Page 10

2 Channel & Accessories

Channel Profiles.....	Page 11
Cantilevers, Angle & Joiners	Page 12
Channel Nuts, Closure Strip, Caps & Trolleys.....	Page 13
Channel Fittings	Page 14
J Hooks, Grommets & Flange Clips.....	Page 15
Purlin Clips, Mounting Plates & Beam Clamps.....	Page 16-17

3 Threaded Consumables

Vertigo Hangers	Page 18
Masonry Fasteners.....	Page 19
Threaded Rod, Nuts,Washers, Coach Screws & Plugs ..	Page 20
Set Screws, Cup Heads & Pan Pozis	Page 21
Tek Screws & Drill Bits.....	Page 22
Rivets & Tools	Page 23

1. Pipe Supports

Insulated Pipe Clamps

HINGED INSULATED PIPE CLAMPS

- Suitable for Copper or PVC Pipes 15NB to 100NB.
- Quick & practical 1 screw lock in system.
- Suits both M8/M10.
- ZP Finish.

Part #	A mm	Ø mm	Box Quantity
389013	12-15mm	15 Cu	150
389019	15-19mm	20 Cu	100
389021	21-23mm	15 Nb	100
389025	25-30mm	25 Cu	100
389032	32-37mm	32 Cu	50
389038	36-39mm	40 Cu	50
389043	40-45mm	40 PVC	50
389051	48-53mm	50 Cu	50
389055	54-58mm	50 PVC	50
389063	62-64mm	65 Cu	50
389069	68-73mm	65 PVC	50
389076	75-80mm	80 Cu	50
389082	82-86mm	80 PVC	50
389102	95-103mm	100 Cu	25
389110	108-116mm	110 PVC	25



INSULATED CLAMPS M8\M10

- Suitable for Steel, Copper or PVC Pipes 125NB to 150NB.
- Suits both M8/M10.
- ZP Finish.

Part #	A mm	Ø mm	Box Quantity
385127	121-127mm	125 Cu	25
385140	133-141mm	125 NB	20
385152	147-153mm	150 Cu	25
385160	159-162mm	150 PVC	20
385165	165-168mm	150 NB	25



1. Pipe Supports

Insulated Pipe Clamps

SUPA SLIDE PIPE CLAMPS

- Suitable for plastic pipes 15NB to 150NB.
- Plastic spacers prevent over tightening.
- Silicon lining to allow pipe to allow pipe movement.
- Suits both M8/M10.
- ZP Finish.

Part #	A mm	Ø mm	Box Quantity
386016	15-20mm	16PPR	50
386020	21-25mm	20PPR	50
386025	26-31mm	25 PPR	50
386032	32-37mm	32 PPR	50
386040	42-46mm	40 PPR	50
386050	50-54mm	50 PPR	50
386056	56-60mm	56 PPR	50
386063	63-68mm	63 PPR	25
386075	75-80mm	75 PPR	25
386090	88-92mm	90 PPR	25
386110	109-114mm	110 PPR	25
386125	112-127mm	125PPR	25
386160	158-163mm	150PPR	25



STAINLESS STEEL INSULATED CLAMPS

- Suitable for Steel, Copper or PVC Pipes 15NB to 150NB.
- Suits both M8/M10.
- G316 SS Finish.

Part #	A mm	Ø mm	Box Quantity
383013	12-15mm	15 Cu	50
383019	15-19mm	20 Cu	50
383021	20-24mm	20 NB	50
383025	25-30mm	25 Cu	50
383032	32-37mm	32/40 Cu	50
383043	40-45mm	40 PVC	50
383051	48-51mm	50 Cu	50
383055	50-56mm	50 PVC	50
383063	59-63mm	65 Cu	25
383069	68-73mm	65 PVC	25
383076	75-80mm	80 Cu	25
383082	82-86mm	80 PVC	25
383089	89-91mm	80 NB	25
383102	95-103mm	100 Cu	25
383110	108-116mm	110 PVC	25
383160	159-162mm	150 PVC	25
383165	165-168mm	150 NB	25



1. Pipe Supports

Stabil Pipe Clamps

STABIL D-3G PIPE CLAMPS

- Available for steel & plastic pipes from 159mm-315mm in diameter.
- Boss connection M12/M16
- Robust G/Bond material 40 x 3mm & 40 x 5mm.

Part #	Description	A mm	Ø mm	Box Quantity
107158	Stabil D-3G ZP	M12/M16	159-165mm	10
107167	Stabil D-3G ZP	M12/M16	167-173mm	10
107185	Stabil D-3G ZP	M12/M16	188-194mm	10
107194	Stabil D-3G ZP	M12/M16	199-205mm	10
107200	Stabil D-3G ZP	M12/M16	219-225mm	10
107219	Stabil D-3G ZP	M12/M16	244-250mm	10
107315	Stabil D-3G ZP	M12/M16	305-315mm	10

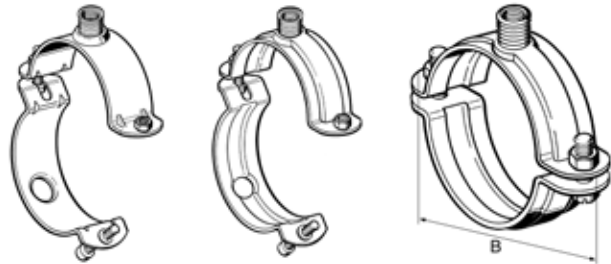

INSULATED STABIL D-3G PIPE CLAMPS

- Available for steel & plastic pipes from 160mm-305mm in diameter.
- Boss connection M12/M16.
- Robust G/Bond material 40mm x 5mm.

Part #	Description	A mm	Ø mm	Box Quantity
11107422	Stabil D-3G ZP	M12/M16	160mm	10
11107440	Stabil D-3G ZP	M12/M16	177-183mm	10
11148911	Stabil D-3G ZP	M12/M16	196-203mm	10
11107477	Stabil D-3G ZP	M12/M16	244-250mm	10
11107495	Stabil D-3G ZP	M12/M16	299-305mm	10

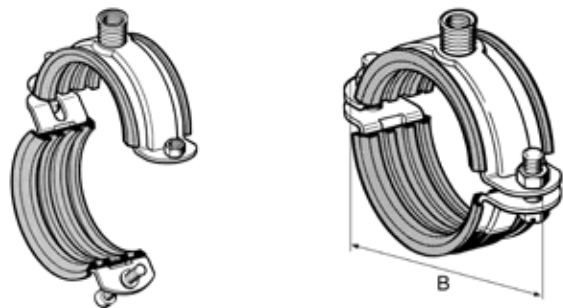

1. Pipe Supports

Channel Clips & Hydrosorbs

HYDROSORBS

- Insulates against heat loss & gain.
- Temperature range -30C to 125C.
- Vibration resistance.
- Fits standard channel.

Part #	Ø mm	NB Size	Box Quantity
35H02	6.5mm Dia Cu	1/4"	25
35H03	10mm Dia Cu	3/8"	25
35H04	12.7mm Dia Cu	1/2"	25
35H05	16mm Dia Cu	5/8"	25
35H06	19mm Dia Cu	3/4"	25
35H07	22mm Dia Cu	7/8"	25
35H08	28mm Dia Cu	1 1/8"	25
35H11	35mm Dia Cu	1 3/8"	25
35H13	41mm Dia Cu	1 5/8"	10
35H17	54mm Dai Cu	2 1/8"	10
35H25	79mm Dia Cu	3 1/8"	5
35H29	92mm Dia Cu	3 5/8"	5
35H33	105mm Dia Cu	4 1/8"	5



CHANNEL CLIPS – ZP

Part #	Description	Ø mm
3581011	EC2025	11mm
3581014	EC2026	14mm
3581017	EC2027	17mm
3581019	EC2028	19mm
3581022	EC2029	22mm
3581025	EC2030	25mm
3581029	EC2031	29mm
3581032	EC2032	32mm
3581035	EC2033	35mm
3581038	EC2034	38mm
3581043	EC2035	43mm
3581049	EC2037	49mm
3581051	EC2038	51mm
3581054	EC2039	54mm
3581057	EC2040	57mm
3581060	EC2041	60mm
3581064	EC2042	64mm
3581067	EC2043	67mm
3581070	EC2044	70mm
3581073	EC2045	73mm
3581076	EC2046	76mm
3581079	EC2047	79mm
3581083	EC2048	83mm

Part #	Description	Ø mm
3581086	EC2049	86mm
3581090	EC2050	90mm
3581095	EC2052	95mm
3581098	EC2053	98mm
3581102	EC2054	102mm
3581111	EC2057	111mm
3581114	EC2058	114mm
3581127	EC2062	127mm
3581140	EC2066	140mm
3581152	EC2070	152mm
3581159	EC2070/62	159mm
3581165	EC2070/64	165mm
3581171	EC2070/66	171mm
3581178	EC2070/70	178mm
3581191	EC2070/74	191mm
3581203	EC2070/80	203mm
3581219	EC2070/86	219mm
3581225	EC2070/225	225mm
3581228	EC2070/228	228mm
3581250	EC2070/250	250mm
3581283	EC2070/283	283mm
3581300	EC2070/300	300mm
3581315	EC2070/315	315mm

1. Pipe Supports

Sprinkler Supports

CNC NUT CLIPS

The full range of sprinkler supports mild steel ZP
Comply to AS/NZ 4680 AS1397
- Pear Bands conform to SAA Code AS2118
- CNC Nut Clips conform to SAA Code AS2118.

Part #	A mm	Ø mm	Box Quantity
35CNC020	25-27mm	20 NB	50
35CNC025	32-34mm	25 NB	50
35CNC032	40-43mm	32 NB	50
35CNC040	48-50mm	40 NB	50
35CNC050	60-63mm	50 NB	50
35CNC065	75-76mm	65 NB	50
35CNC080	89-90mm	80 NB	25
35CNC100	110-114mm	100 NB	25
35CNC125	140-143mm	125 NB	25
35CNC150	165-168mm	150 NB	25



PEAR BAND HANGING CLIP

35EPB027	27mm	20 NB	50
35EPB034	34mm	25 NB	50
35EPB043	43mm	32 NB	25
35EPB048	48mm	40 NB	25
35EPB060	60mm	50 NB	25
35EPB076	76mm	65 NB	25
35EPB089	89mm	80 NB	25
35EPB114	114mm	100 NB	25
35EPB165	165mm	150 NB	25



LIGHT DUTY PIPE SADDLES (SHALLOW)

35CLS025	32mm	25 NB	50
35CLS032	43mm	32 NB	50
35CLS048	48mm	40 NB	25
35CLS060	60mm	50 NB	25
35CLS076	76mm	65 NB	25

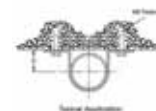

LIGHT DUTY PIPE SADDLES (DEEP)

35CDS025	34mm	25 NB	50
35CDS032	43mm	32 NB	25
35CDS040	48mm	40 NB	25
35CDS050	60mm	50 NB	25



LIGHT DUTY PIPE TWIST CLIPS

35CTC025	32mm	25 NB	50
35CTC032	43mm	32 NB	50
35CTC040	48mm	40 NB	25
35CTC050	60mm	50 NB	25
35CTC065	76mm	65 NB	25



1. Pipe Supports

Heavy Duty U Bolts, Guides & Grips

U BOLT GRIP HEAVY DUTY

- Suitable for steel pipes 15NB to 400NB.
- Complete with 2 hex nuts and 2 lock nuts.
- Standard HDG finish.

Part #	Ø mm	Thread Size	NB Size	Box Quantity
42UBC015	21mm	M8	15 NB	100
42UBC020	27mm	M8	20 NB	50
42UBC025	34mm	M8	25 NB	50
42UBC032	43mm	M8	32 NB	50
42UBC040	48mm	M10	40 NB	50
42UBC050	60mm	M10	50 NB	50
42UBC065	76mm	M12	65 NB	50
42UBC080	89mm	M16	80 NB	25
42UBC100	114mm	M16	100 NB	25
42UBC125	141mm	M16	125 NB	10
42UBC150	168mm	M20	150 NB	10
42UBC200	219mm	M20	200 NB	10
42UBC250	273mm	M20	250 NB	10
42UBC300	323mm	M24	300 NB	5
42UBC350	355mm	M24	350 NB	5
42UBC400	406mm	M24	400 NB	5



U BOLT GUIDE HEAVY DUTY

- Suitable for steel pipes 15NB to 400NB.
- Complete with 2 hex nuts and 2 lock nuts.
- Standard HDG finish.

Part #	Ø mm	Thread Size	NB Size	Box Quantity
42UBG015	21mm	M8	15 NB	100
42UBG020	27mm	M8	20 NB	50
42UBG025	34mm	M8	25 NB	50
42UBG032	43mm	M8	32 NB	50
42UBG040	48mm	M10	40 NB	50
42UBG050	60mm	M10	50 NB	50
42UBG065	76mm	M12	65 NB	50
42UBG080	89mm	M16	80 NB	25
42UBG100	114mm	M16	100 NB	25
42UBG125	141mm	M16	125 NB	10
42UBG150	168mm	M20	150 NB	10
42UBG200	219mm	M20	200 NB	10
42UBG250	273mm	M20	250 NB	10
42UBG300	323mm	M24	300 NB	5
42UBG350	355mm	M24	350 NB	5
42UBG400	406mm	M24	400 NB	5



1. Pipe Supports

U Bolts, Medium Duty Clamps & Saddles

STANDARD U BOLT

- Suitable for steel pipes 15NB to 250NB.
- Complete with 2 hex nuts.
- Standard HDG finish.

Part #	Ø mm	Thread Size	NB Size	Box Quantity
42U020	27mm	M10	20 NB	50
42U025	34mm	M10	25 NB	50
42U032	43mm	M10	32 NB	50
42U040	48mm	M10	40 NB	50
42U050	60mm	M10	50 NB	50
42U065	76mm	M12	65 NB	50
42U080	89mm	M12	80 NB	25
42U100	114mm	M12	100 NB	25
42U125	141mm	M12	125 NB	10
42U150	168mm	M12	150 NB	10
42U200	219mm	M16	200 NB	10
42U250	273mm	M20	250 NB	10

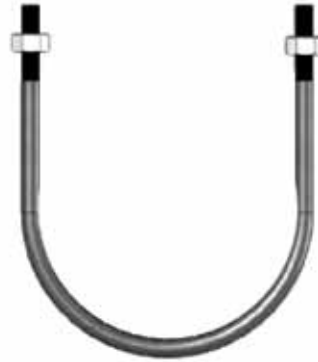

MEDIUM DUTY 2 BOLT CLAMPS

- Standard finish HDG.
- Complete with bolts & nuts.
- 40mm x 5mm material.

Part #	Description	Ø mm	NB Size	Box Quantity
35163060	ER16-060	60mm	50 NB	25
35163076	ER16-076	76mm	65 NB	10
35163089	ER16-089	89mm	80 NB	10
35163102	ER16-102	102mm	100 Cu	10
35163114	ER16-114	114mm	100 NB	10
35163127	ER16-127	127mm	125 Cu	10
35163140	ER16-140	140mm	125 NB	10
35163152	ER16-152	152mm	150 Cu	5
35163165	ER16-165	165mm	150 NB	5
35163203	ER16-203	203mm	200 Cu	5
35163219	ER16-219	219mm	200 NB	5
35163250	ER16-250	250mm	225 PVC	5
35163273	ER16-273	273mm	250 NB	5
35163303	ER16-303	303mm	300 Cu	5
35163315	ER16-315	315mm	300 PVC	5
35163400	ER16-400	400mm	375 PVC	5



CLEVIS HANGERS

- Standard finish HDG.
- Allows adjustment for suspending pipes.

Part #	Description	A mm	Ø mm	Box Quantity
35CH01	Light Duty Clevis	M10	25 x 3mm	100
35CH02	Medium Duty Clevis	M12	40 x 5mm	25
35CH03	Heavy Duty Clevis	M16	40 x 5mm	25
35ERC1010	Female Clevis Eye		M10	100

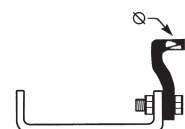

1. Pipe Supports

U Bolts, Medium Duty Clamps & Saddles

MEDIUM DUTY ADJUSTABLE YOKE CLAMP

- Standard finish HDG.
- Complete with bolts & nuts.
- 40mm x 5mm material.

Part #	Description	Ø mm	NB Size	Box Quantity
35183089	ER18-089	89mm	80 NB	10
35183102	ER18-102	102mm	100 Cu	10
35183114	ER18-114	114mm	100 NB	10
35183127	ER18-127	127mm	125 Cu	10
35183140	ER18-140	140mm	125 NB	10
35183152	ER18-152	152mm	150 Cu	5
35183165	ER18-165	165mm	150 NB	5
35183200	ER18-203	203mm	200 Cu	5
35183219	ER18-219	219mm	200 NB	5
35183250	ER18-250	250mm	225 PVC	5
35183203	ER18-303	303mm	300 Cu	5
35183315	ER18-315	315mm	300 PVC	5



MEDIUM DUTY SADDLES

- Standard HDG finish.
- 40mm x 5mm material.

Part #	Description	Ø mm	NB Size	Box Quantity
35153027	ER15-027	27mm	20 NB	25
35153034	ER15-034	34mm	25 NB	25
35153042	ER15-042	42mm	32 NB	25
35153048	ER15-048	48mm	40 NB	25
35153060	ER15-060	60mm	50 NB	25
35153076	ER15-076	76mm	65 NB	10
35153089	ER15-089	89mm	80 NB	10
35153102	ER15-102	102mm	100 Cu	10
35153114	ER15-114	114mm	100 NB	10
35153152	ER15-152	152mm	150 Cu	5
35153165	ER15-165	165mm	150 NB	5
35153203	ER15-203	203mm	200 Cu	5
35153219	ER15-219	219mm	200 NB	5

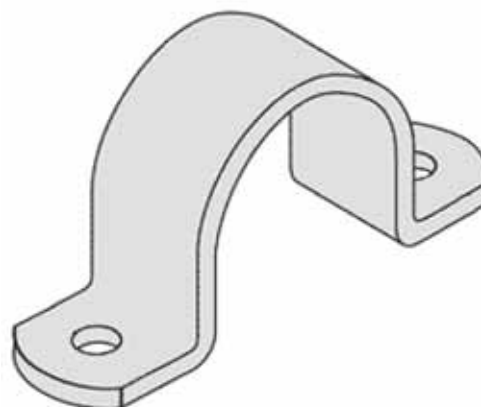

1. Pipe Supports

Isolation Barrier, BARRNOGS & Blocks

ISOLATION BARRIER

- Forms a protective barrier between pipes & clamps.
- Available in Silicon for outdoor & UV applications.
- Plastic for indoor applications.

Part #	Description	A mm	Box Quantity
35ZS	Silicon Barrier	7.5m Roll	1
35ZIS	Plastic Barrier	10m Roll	1

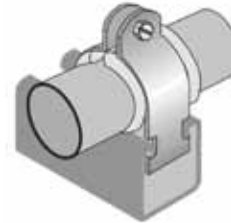

BARRNOG

- Revolutionary adjustable noggin.
- Simply slide the BARRNOG to required size & fix.
- Installed in seconds, saves time & money.
- Greater strength & more accurate fit.
- Reduces the risk of water hammer.
- Galvabond finish.

Part #	Description	A mm	Box Quantity
37BARRNOG	Adjustable Noggin	Up to 600mm	10

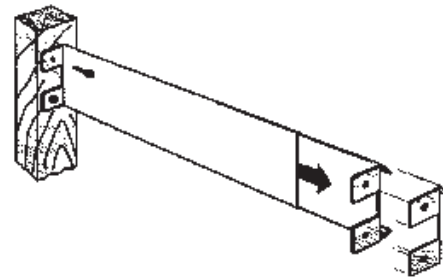

WOODEN & CORK BLOCK INSULATORS

Wooden & Cork Blocks are available in both Round & Flat bottom type, for refrigeration & chilled water applications.

When ordering please specify the following.

- Material required (Cork or Wood)
- Type A (Round) Type B (Flat Bottom)
- Pipe diameter in mm
- Wall thickness in mm

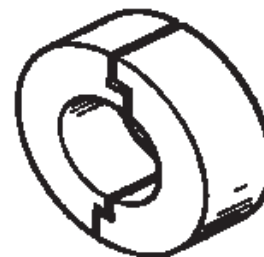

Please note wall thickness may vary in accordance with clamp sizes.

1. Pipe Supports

GAS BOXES & ACCESSORIES

Part #	Description	Dimensions
50A11	Domestic Gas Box GB	
50A11WL	Domestic Gas Box C/W Window & Lock	460 x 505 x 270
50A11-D	Domestic Gas Box Standard Door	
50A11-DW	Domestic Gas Box Door c/w Window	
50DGBM	Domestic Gas Box Manifold	
50DGBS	Domestic Gas Box Stand	1480 x 325
50A12	Commercial Gas Box GB	610 x 610 x 370
50CGBS	Commercial Gas Box Stand	1800 x 415 HDG



2. Channel and Accessories

Channel Profiles

HEAVY DUTY 2.5MM THICKNESS

Part #	Size mm	Finish	Box Quantity
36ES1000-6	41 x 41 x 6 Mtr	HDG	1
36ES3300-6	41 x 21 x 6 Mtr	HDG	1
36ES1000-3	41 x 41 x 3 Mtr	HDG	1
36ES3300-3	41 x 21 x 3 Mtr	HDG	1
36ES5500-6	41 x 62 x 6 Mtr	HDG	1
36ES1001-6	41 x 82 x 6 Mtr	HDG	1
36ES1000-GB	41 x 41 x 6 Mtr	G/Bond	1
36ES3300-GB	41 x 21 x 6 Mtr	G/Bond	1
36ESS1000-6	41 x 41 x 6 Mtr	S/Steel	1
36ESS3300-6	41 x 21 x 6 Mtr	S/Steel	1



ES1000



ES3300



ES1000T



ES3300T

HEAVY DUTY 2.5MM THICKNESS SLOTTED

Part #	Size mm	Finish	Box Quantity
36ES1000T-6	41 x 41 x 6 Mtr	HDG	1
36ES3300T-6	41 x 21 x 6 Mtr	HDG	1
36ES1000T-3	41 x 41 x 3 Mtr	HDG	1
36ES3300T-3	41 x 21 x 3 Mtr	HDG	1

LIGHT DUTY 1.6MM THICKNESS

Part #	Size mm	Finish	Box Quantity
36ES2000-6	41 x 41 x 6 Mtr	G/Bond	1
36ES4000-6	41 x 21 x 6 Mtr	G/Bond	1



ES4000

Mass: 1.26kg/m

LIGHT DUTY 1.6MM THICKNESS SLOTTED

Part #	Size mm	Finish	Box Quantity
36ES2000T-6	41 x 41 x 6 Mtr	G/Bond	1
36ES4000T-6	41 x 21 x 6 Mtr	G/Bond	1



ES2000T



ES4000T

FIBREGLASS

Part #	Size mm	Finish	Box Quantity
36FG1000-3	41 x 41 x 3 Mtr	Fibreglass	1
36FG3300-6	41 x 21 x 6 Mtr	Fibreglass	1

ALUMINUM

Part #	Size mm	Finish	Box Quantity
36ES2000AL	41 x 41 x 6 Mtr	Aluminum	1
36ES4000AL	41 x 21 x 6 Mtr	Aluminum	1

2. Channel and Accessories

Cantilevers, Angle & Joiners

CADDY CANTILEVER BRACKETS STANDARD (NO BRACE)

Part #	Size mm	Finish	Box Quantity
36CL150	150mm Long	HDG	1
36CL300	300mm Long	HDG	1
36CL450	450mm Long	HDG	1
36CL600	600mm Long	HDG	1
36CL750	750mm Long	HDG	1



CADDY CANTILEVER BRACKETS BRACED TYPE

Part #	Size mm	Finish	Box Quantity
36CL320B	320mm Long	HDG	1
36CL470B	470mm Long	HDG	1
36CL640B	640mm Long	HDG	1
36CL780B	780mm Long	HDG	1

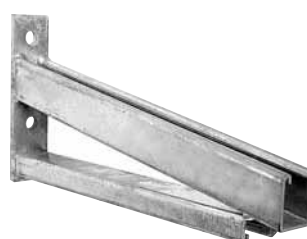

SLOTTED ANGLE ZP

Part #	Description	Length	Box Quantity
36A3030	30 X 30 Slotted Angle	3m	10
36A5050	50 X 50 Slotted Angle	3m	10



CADDY JOINER EXTERNAL ZP

Part #	Description	Box Quantity
36J2377	External Channel Joiner	50

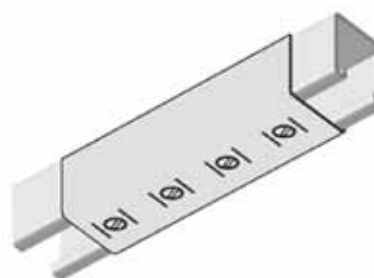

CADDY JOINER INTERNAL ZP

Part #	Description	Box Quantity
36J922	Internal Channel Joiner	50

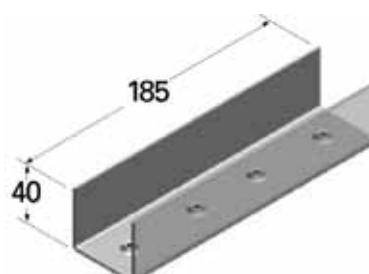

2. Channel and Accessories

Channel Nuts, Closure Strip, Caps & Trolleys

Channel Nuts also available in HDG and SS finishes.

CHANNEL NUTS (NO SPRING)

Part #	Size mm	Finish	Box Quantity
36NT06	M6 Trunking Nuts	ZP	100
36NN06	M6 No Spring Nuts	ZP	100
36NN08	M8 No Spring Nuts	ZP	100
36NN10	M10 No Spring Nuts	ZP	100
36NN12	M12 No Spring Nuts	ZP	100
36NN16	M16 No Spring Nuts	ZP	100



CHANNEL NUTS (SHORT SPRING)

Part #	Size mm	Finish	Box Quantity
36NS06	M6 Short Spring Nuts	ZP	100
36NS08	M8 Short Spring Nuts	ZP	100
36NS10	M10 Short Spring Nuts	ZP	100
36NS12	M12 Short Spring Nuts	ZP	100
36NS16	M16 Short Spring Nuts	ZP	100



CHANNEL NUTS (LONG SPRING)

Part #	Size mm	Finish	Box Quantity
36NL06	M6 Long Spring Nuts	ZP	100
36NL08	M8 Long Spring Nuts	ZP	100
36NL10	M10 Long Spring Nuts	ZP	100
36NL12	M12 Long Spring Nuts	ZP	100
36NL16	M16 Long Spring Nuts	ZP	100



PRE-MOUNTED CHANNEL NUTS

Part #	Size mm	Finish	Box Quantity
36NP08040	M8 x 40 Pre-Mounted Nut	ZP	100
36NP10040	M10 x 40 Pre-Mounted Nut	ZP	100



CLOSURE STRIP

Part #	Size mm	Finish	Box Quantity
36313309	Grey suit 41mm Channel	Plastic	1
36313311	Aluminium suit 41mm Channel	Aluminum	1



CHANNEL END CAPS

Part #	Size mm	Finish	Box Quantity
362240	Grey suit 41mm Channel	Plastic	100
3624240	Grey suit 21mm Channel	Plastic	100



CHANNEL TROLLEYS

Part #	Size mm	Finish	Box Quantity
362749	2 Wheel suit 41mm Channel	ZP	25
362950	4 Wheel suit 41mm Channel	ZP	25

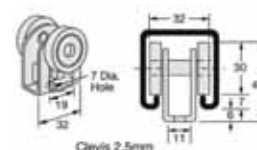

2. Channel and Accessories

Channel Fittings

CADDY CHANNEL FITTINGS		
Part #	Description	Box Quantity
36387495	ZEA111	10
36387500	ZEA100	10
36387520	ZEA102	10
36387530	ZEA103	10
36387540	ZEA104	10
36387560	ZEA106	10
36387570	ZEA107	10
36387580	ZEA108	10
36387590	ZEA109	10
36387450	ZEA110	10
36388270	ZGA501	10
36387740	ZSA301	10
36387701	ZTA601	10
36387702	ZTA602	10
36388080	ZTA605	10
36313270	ZT606	10
36387750	ZUA400	10
36387760	ZUA401	10
36387600	ZWA200	100
36387620	ZWA202	10
36387650	ZWA205	10
36387670	ZWA207	10
36387690	ZWA209	10
36387890	ZWA214	10
36387900	ZWA215	10
36388400	ZZA701	10
36387720	ZZA702	10
36313870	ZZ704	10
36P11	P11000HD	10
36P13	P13000HD	10

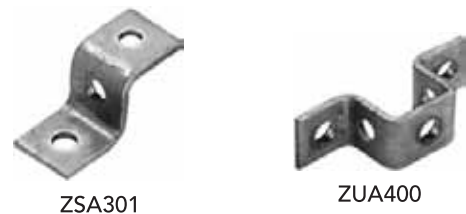

2. Channel and Accessories

J Hooks, Grommets & Flange Clips

CAT 32HP			
Part # / Description	A mm	Ø mm	Box Quantity
32CAT32HP		50	60

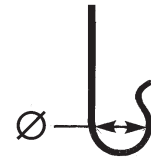

CAT 4Z34/6Z34			
Part # / Description	A mm	Ø mm	Box Quantity
32CAT32HP4Z34	M4-M8	50	60
32CAT32HP6Z34	M8-M12	50	60



ESGP GROMMET				
Part #	Description	A mm	Ø mm	Box Quantity
31ESGP	Anti Rattle Grommet		34	100

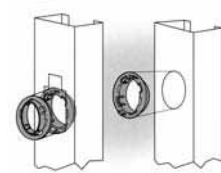

MSP PUNCH				
Part #	Description	A mm	Ø mm	Box Quantity
31MSP20	Metal Stud Punch		34	1

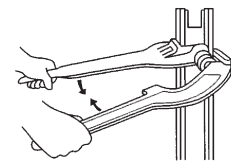
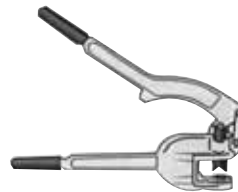

H-CLIP			
Part # / Description	A mm	Ø mm	Box Quantity
312H4	2-3	N/A	100
314H24	3-8	N/A	100
314H58	8-14	N/A	100
314H912	14-20	N/A	100

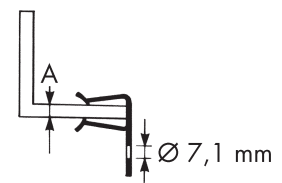

H-CT CLIP			
Part # / Description	A mm	Ø mm	Box Quantity
312H4CT	2-3	N/A	100
314H24CT	3-8	N/A	100
314H58CT	8-14	N/A	100
314H912CT	14-20	N/A	100

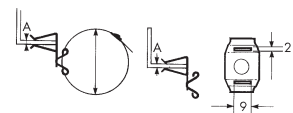

APC CLIP			
Part # / Description	A mm	Ø mm	Box Quantity
31APC	1.5-4	N/A	100

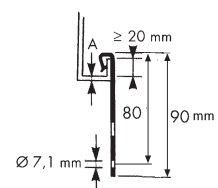

2. Channel and Accessories

Purlin Clips, Mounting Plates & Beam Clamps

D1 CLIPS

Part # / Description	A mm	Ø mm	Box Quantity
34D1M08	≤4	9	100
34D1M10	≤4	11	100
34D1M12	≤4	13	100

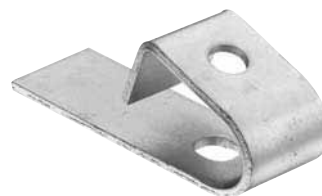

E2 CLIPS

Part # / Description	A mm	Ø mm	Box Quantity
34E2M08-TI	≤4	M8	100
34E2M10-TI	≤4	M10	100
34E2M12-TI	≤4	M12	100



CMP PLATE

Part # / Description	A mm	Ø mm	Box Quantity
34CMPM08-TI	N/A	M8	100
34CMPM10-TI	N/A	M10	100
34CMPM12-TI	N/A	M12	100



VMP PLATE

Part # / Description	A mm	Ø mm	Box Quantity
34VMPM08-TI	N/A	M8	100
34VMPM10-TI	N/A	M10	100
34VMPM12-TI	N/A	M12	100



MMP PLATE

Part # / Description	A mm	Ø mm	Box Quantity
34MMPM10	N/A	M10	100



HMP PLATE

Part # / Description	A mm	Ø mm	Box Quantity
34HMPM10	N/A	M10	100



2. Channel and Accessories

Purlin Clips, Mounting Plates & Beam Clamps

TKN CLAMPS Z/P

Part # / Description	A mm	Ø mm	Box Quantity
34TKN8	18	9	100
34TKN10	20	11	100
34TKN12	26	13	80



310 CLAMPS

Part # / Description	A mm	Ø mm	Box Quantity
34BTK10	32	M10	100
34BTK12	32	M12	50



HB2 CLAMPS

Part # / Description	A mm	Ø mm	Box Quantity
34HB2-3 (HDG)	≤24	N/A	50
34HB2 (ZP)	≤24	N/A	50



WEDGE NUTS

Part # / Description	A mm	Ø mm	Box Quantity
34HW6		M6	100
34HW8		M8	100
34HW10		M10	100
34HW12		M12	100

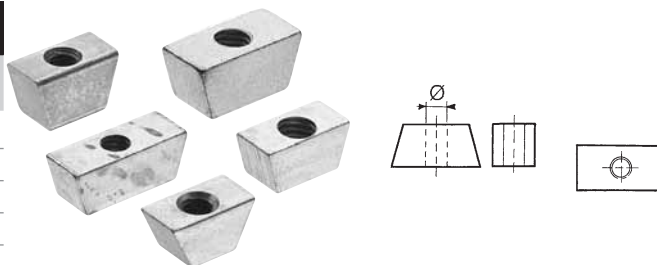

VF14 CLIPS

Part # / Description	A mm	Ø mm	Box Quantity
31VF14	1.5-6		100
31VF14M6TI	1.5-6	M6	100
31VF14M8TI	1.5-6	M8	100
31VF14M10TI	1.5-6	M10	100

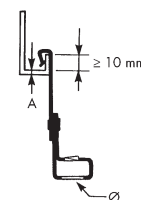
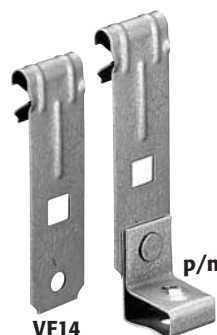

3. Threaded Consumables

Vertigo Hangers

**For fixing direct to concrete, timber & steel trusses.
Vertical or side hangers.**

Vertigo is a one-piece all steel threaded rod hanger. It can be installed into steel truss, purlins, timber joists as well as concrete. Supports 6mm - 10mm threaded rod.

Simply insert the required Vertigo into the appropriate driver & install using a cordless drill.

VERTICAL HANGER FOR STEEL

Part #	Description	Box Quantity
186308	8mm Rod Hanger	100
186310	10mm Rod Hanger	100

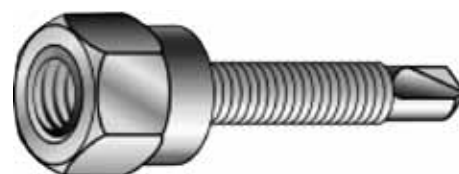

SIDE HANGER FOR STEEL

Part #	Description	Box Quantity
186208	8mm Rod Hanger	100
186210	10mm Rod Hanger	100

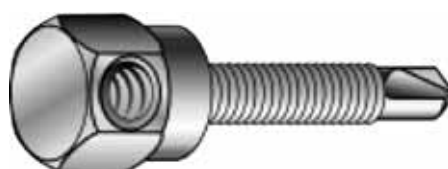

VERTICAL HANGER FOR TIMBER

Part #	Description	Box Quantity
186508	8mm Rod Hanger	100
186510	10mm Rod Hanger	100



SIDE HANGER FOR TIMBER

Part #	Description	Box Quantity
186620	10mm Rod Hanger	100



VERTICAL HANGER FOR CONCRETE

Part #	Description	Box Quantity
186110	10mm Rod Hanger	100

DRIVING SOCKETS

Part #	Description	Box Quantity
186000	Timber/Steel "Red"	1
186001	Concrete "Blue"	1



3. Threaded Consumables

Masonry Fasteners

STRIKE ANCHORS

Part #	Anchor Dia x Length mm	Drill Hole Dia mm	Box Quantity
41ESA0850	8 x 50	8	60
41ESA1050	10 x 50	10	40

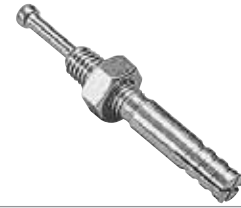

SLEEVE ANCHOR HEX NUT (DYNABOLT) ZP

Part #	Anchor Dia x Length mm	Drill Hole Dia mm	Box Quantity
41485010	6.5 x 25	6.5	100
41485050	6.5 x 36	6.5	100
41485250	8 x 40	8	100
41485300	8 x 65	8	100
41485440	10 x 40	10	100
41485450	10 x 50	10	100
41485475	10 x 75	10	50
41485600	10 x 97	10	50
41485760	12 x 60	12	50



DROP IN ANCHOR, FLANGED TYPE ZP

Part #	Anchor Dia x Length mm	Drill Hole Dia mm	Box Quantity
41525220	6 x 25	8	100
41525230	8 x 30	10	100
41525235	10 x 30	12	50
41525235B	10 x 30	12	500
41525260	12 x 50	15	50
41525270	16 x 65	20	25
41525280	20 x 80	25	25



ALL METAL DRIVE ANCHOR (METAL TAP-INS) ROUND HEAD

Part #	Anchor Dia x Length mm	Drill Hole Dia mm	Box Quantity
41545700	5 x 25	5	100
41545720	6.5 x 32	6.5	100
41545740	6.5 x 50	6.5	100



NYLON DRIVE ANCHOR (NYLON TAP-INS) ROUND HEAD

Part #	Anchor Dia x Length mm	Drill Hole Dia mm	Box Quantity
41545540	5 x 25	5	100
41545458	5 x 40	5	100
41545560	6.5 x 25	6.5	100
41545570	6.5 x 40	6.5	100
41545580	6.5 x 50	6.5	100



HEADLESS SCREW

Part #	Type	Thread Connection	Total Length mm	Box Quantity
41585080	M10/80mm	M10 x 30	80	100
41585100	M10/100mm	M10 x 30	100	100

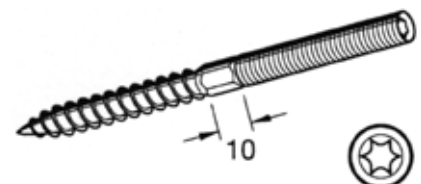

3. Threaded Consumables

Threaded Rod, Nuts, Washers, Screws & Plugs

THREADED ROD

Part #	Diameter	Finish	Length
42RM06	M6	ZP & HDG & SS	3m
42RM08	M8	ZP & HDG & SS	3m
42RM10	M10	ZP & HDG & SS	3m
42RM12	M12	ZP & HDG & SS	3m
42RM16	M16	ZP & HDG & SS	3m
42RM20	M20	ZP & HDG & SS	3m



ROD COUPLERS

Part #	Diameter	Finish
42CM06	M6	ZP & HDG & SS
42CM08	M8	ZP & HDG & SS
42CM10	M10	ZP & HDG & SS
42CM12	M12	ZP & HDG & SS
42CM16	M16	ZP & HDG & SS
42CM20	M20	ZP & HDG & SS

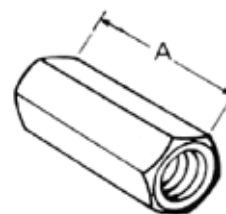

HEX NUTS

Part #	Diameter	Finish
42NHZM06	M6	ZP & HDG & SS
42NHZM08	M8	ZP & HDG & SS
42NHZM10	M10	ZP & HDG & SS
42NHZM12	M12	ZP & HDG & SS
42NHZM16	M16	ZP & HDG & SS
42NHZM20	M20	ZP & HDG & SS



FLAT WASHERS

Part #	Diameter	Finish
42WFZM06	M6	ZP & HDG & SS
42WFZM08	M8	ZP & HDG & SS
42WFZM10	M10	ZP & HDG & SS
42WFZM12	M12	ZP & HDG & SS
42WFZM16	M16	ZP & HDG & SS
42WFZM20	M20	ZP & HDG & SS

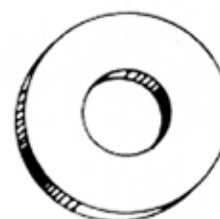

SPRING WASHERS

Part #	Diameter	Finish
42WSZM06	M6	ZP & HDG & SS
42WSZM08	M8	ZP & HDG & SS
42WSZM10	M10	ZP & HDG & SS
42WSZM12	M12	ZP & HDG & SS
42WSZM16	M16	ZP & HDG & SS
42WSZM20	M20	ZP & HDG & SS



COACH SCREWS/PLUGS

Part #	Diameter	Finish
41CS0850	M8 x 50	ZP
41CS1065	M10 x 65	ZP
41CSP1050	M10 x 50	Nylon
41CSP12060	M12 x 60	Nylon



FRAME ANCHOR

Part #	Description	Box Quantity
41560235	M10 x 80 C/W Plug	100
41560240	M10 x 100 C/W Plug	100



3. Threaded Consumables

Sets Screws, Cup Heads & Pan Pozis

METRIC COMMERCIAL HEX HEAD SET SCREWS ZP

Part #	Diameter	Finish
42S06010	M6 x 10 Set Screws	ZP
42S06020	M6 x 20 Set Screws	ZP
42S06025	M6 x 25 Set Screws	ZP
42S06030	M6 x 30 Set Screws	ZP
42S06040	M6 x 40 Set Screws	ZP
42S08020	M8 x 20 Set Screws	ZP
42S08025	M8 x 25 Set Screws	ZP
42S08030	M8 x 30 Set Screws	ZP
42S08040	M8 x 40 Set Screws	ZP
42S08050	M8 x 50 Set Screws	ZP
42S10020	M10 x 20 Set Screws	ZP
42S10025	M10 x 25 Set Screws	ZP
42S10030	M10 x 30 Set Screws	ZP
42S10040	M10 x 40 Set Screws	ZP
42S10050	M10 x 50 Set Screws	ZP
42S10065	M10 x 65 Set Screws	ZP
42S12025	M12 x 25 Set Screws	ZP
42S12030	M12 x 30 Set Screws	ZP
42S12040	M12 x 40 Set Screws	ZP
42S12050	M12 x 50 Set Screws	ZP
42S12060	M12 x 60 Set Screws	ZP
42S12075	M12 x 75 Set Screws	ZP

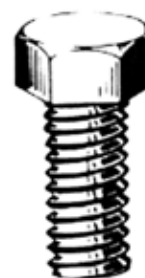

METRIC CUP HEAD MILD STEEL BOLTS & NUTS ZP

Part #	Diameter	Finish
42BN06025	M6 x 25 Cup Head	ZP
42BN08025	M8 x 25 Cup Head	ZP
42BN08040	M8 x 40 Cup Head	ZP
42BN10025	M10 x 25 Cup Head	ZP
42BN10030	M10 x 30 Cup Head	ZP



METRIC PAN HEAD METAL THREAD SCREWS POZI DRIVE ZP

Part #	Diameter	Finish
42B06016	M6 x 16 Pan Pozis	ZP
42B06020	M6 x 20 Pan Pozis	ZP
42B06025	M6 x 25 Pan Pozis	ZP
42B06030	M6 x 30 Pan Pozis	ZP
42B08025	M8 x 25 Pan Pozis	ZP
42B08030	M8 x 30 Pan Pozis	ZP
42B08040	M8 x 40 Pan Pozis	ZP
42BC05012	M5 x 12 Csk Pozis	ZP
42BC06016	M6 x 16 Csk Pozis	ZP



**Other sizes are available on request.
Also Available in HDG & STAINLESS STEEL FINISH.**

3. Threaded Consumables

Tek Screws and Drill Bits

SELF DRILLING FOR METAL CLASS 3

Part #	Description	Size
183308012	Hex Head	8-18x12
183310016	Hex Head	10-16x16
183310025	Hex Head	10-16x25
183312020	Hex Head	12-14x20
183312532	Hex Head Series 500	12-24x32
183310116	Hex Head w/-Neo Washer	10-16x16
183308412	Button Head	8-18x12
183310216	Wafer Head	10-16x16



SELF DRILLING FOR METAL CLASS 2

Part #	Description	Size
183208312	Button Head	8-18x12
183208320	Button Head	8-18x20
183210216	Wafer Head	10-16x16



SELF DRILLING FOR TIMBER CLASS 3

Part #	Description	Size
183T312025	Hex Head	12-11x25

HSS DRILL BITS

Part #	Description	Size
15DE30	Double End	No30
15DE20	Double End	No20
15DE11	Double End	No11
15STUB30	Stub	No30
15STUB20	Stub	No20
15STUB11	Stub	No11
15JOB6.5	Jobber	6.5mm
15JOB10.5	Jobber	10.5mm



SDS MULTI-FIT MASONRY DRILL BITS

Part #	Description	Size
152D050110	SDS Multi-Fit	M5 x 110
152D065110	SDS Multi-Fit	M6.5 x 110
152D080160	SDS Multi-Fit	M8 x 160
152D100160	SDS Multi-Fit	M10 x 160
152D120160	SDS Multi-Fit	M12 x 160
152D150160	SDS Multi-Fit	M15 x 160
152D160160	SDS Multi-Fit	M16 x 160
152D200200	SDS Multi-Fit	M20 x 200
152D250250	SDS Multi-Fit	M25 x 250



3. Threaded Consumables

Pop Rivets **Other sizes and materials are available.**

ALUMINIUM RIVETS WITH STEEL STEM

Part #	Description	Size
06AS402	3.2mm dia x 3.2 max grip	4-2
06AS403	3.2mm dia x 4.8 max grip	4-3
06AS404	3.2mm dia x 6.4 max grip	4-4
06AS604	4.8mm dia x 6.4 max grip	6-4



ALUMINIUM SEALED RIVET

Part #	Description	Size
06TA4-3	3.2mm dia x 4.8 max grip	4-3
06SR01-4812	4.8mm dia x 8.0 max grip	6-5

STEEL RIVETS WITH STEEL STEM

Part #	Description	Size
06SSP402	3.2mm dia x 3.2 max grip	4-2
06SSP403	3.2mm dia x 4.8 max grip	4-3
06SSP404	3.2mm dia x 6.4 max grip	4-4
06SSP504	4.2mm dia x 6.4 max grip	5-4
06SSP604	4.8mm dia x 6.4 max grip	6-4

S/STEEL RIVETS WITH S/STEEL STEM

Part #	Description	Size
06STST402	3.2mm dia x 3.2 max grip	4-2
06STST403	3.2mm dia x 4.8 max grip	4-3
06STST404	3.2mm dia x 6.4 max grip	4-4
06STST604	4.8mm dia x 6.4 max grip	6-4

THREADED ROD CUTTER

- 10mm Rod Cutters can cut 6mm, 8mm, and 10mm threaded mild steel rod with little effort.
- No damage to thread after cutting.
- Easy to operate and quick cutting time.
- Body weighs 4.5kg.
- Overall length 765mm.
- 12mm Rod Cutters also available.
- Replacement dies available.

Part #	Description
42RCM10	Rod Cutter M10
42RCM12	Rod Cutter M12
42RDM06	M6 Die For Rod Cutter
42RDM08	M8 Die For Rod Cutter
42RDM10	M10 Die For Rod Cutter
42RDM12	M12 Die For Rod Cutter



DROP-IN SETTING TOOL

Part #	Description	Box Quantity
41243740	M8	1
41230935	M10	1
41243743	M12	1
41243744	M16	1
41243745	M20	1



*Delivering a Quality, Competitive Construction
Support System on Time on Budget*



11 Cowcher Place Belmont WA 6104
Phone: (08) 6278 7500 Fax: (08) 6278 7599
Web Site: www.caddyindustrial.com.au
Email: sales@caddyindustrial.com.au